

Stainless steel LED handrail system

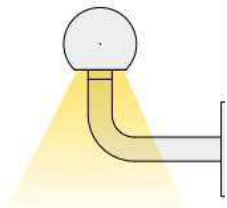

Beam Angle 110°

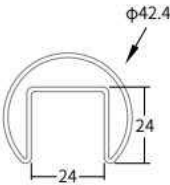
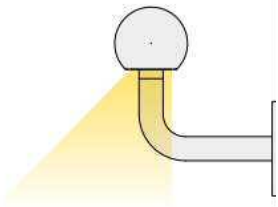

Beam Angle 70°
(Asymmetric)

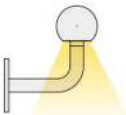
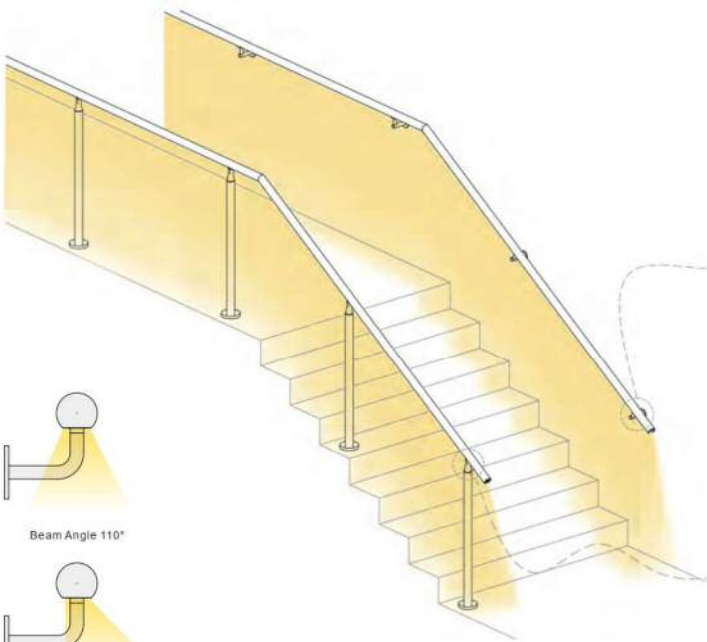

Beam Angle 110°

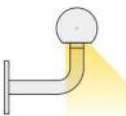

Beam Angle 70°
(Asymmetric)

Stainless LED Lighted Railing-D42.4

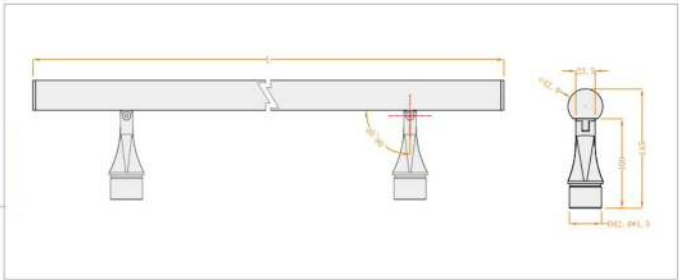
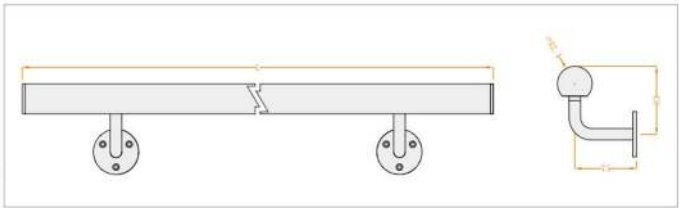

ACCESSORIES

						
1 D42.4 handrail	2 Al profile	3 Diffuser	4 Asymmetric diffuser	5 IP65 LED strip	6 End cap B for LED strip	7 standing holder
Part No. 1.05.099 Net weight: 1761 g/m	Part No. 1.05.099 1.01.05.0362 (Self-tapping screws) Net weight: 309 g/m	Part No. 1.04.02.98 Net weight: 102 g/m	Part No. 1.04.02.98 Net weight: 128 g/m	Part No. 9.0613 Suitable for 10MM width LED Strip Net weight: 940 g/10m	Part No. 1.03.01.0499 Net weight: 24 g	Part No. 2.02.HL.002 Net weight: 268 g

					
8 wall mounting holder	9 straight connector	10 Handrail end cap	11 90 degree connector	12 turn round connector	
Part No. 2.02.HL.003 Net weight: 233 g	Part No. 1.01.08.0143 Net weight: 95 g	Part No. 1.01.04.99.0028 Net weight: 72 g	Part No. 1.01.08.0152 Net weight: 350 g	Part No. 1.01.08.0149 (A) 1.01.08.0145 (B) 1.01.08.0150 (C) Net weight: 297 g	

Basic Parameter

LED Brand	2835
LED Q'ty	120 PCS/M
Dimension	L1000*φ42.4mm
Lamp housing material	Stainless steel
Cover (Diffuser)	PC
Working Temperature	-20~+45 °C
IP Class	IP65
Beam Angle	110 °(Symmetric) , 70°(Asymmetric)

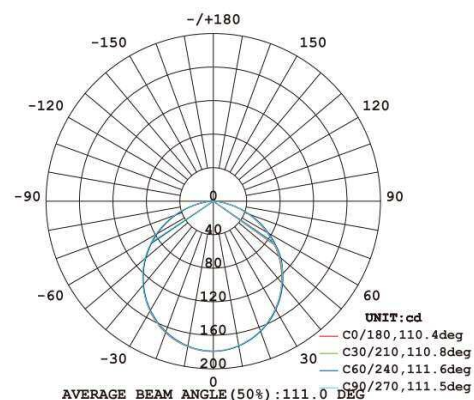

Electrical Parameter

Power	15W/M
Input Voltage	24V DC

Optical Parameter

CCT	2500K 2700K 3000K 4000K 6000K
Luminous Flux	957 Lm(Symmetric) 921 Lm(Asymmetric)
Luminous Efficiency	63.8 Lm/W(Symmetric) 61.4 Lm/W(Asymmetric)
CRI	≥80

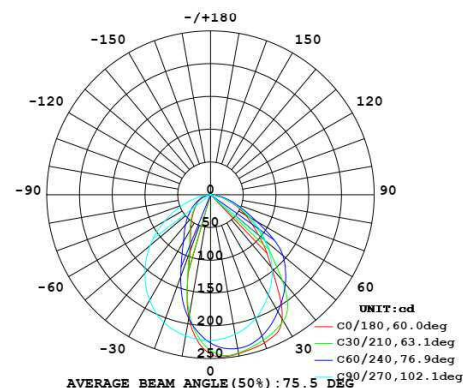

Light Distribution Curve

Above information for reference purpose!

INSTALLATION MANUAL

